

Return Address
Walla Walla County Commissioners
PO BOX 1506
Walla Walla, WA 99362

Document Titles (i.e.: type of document)

ORDINANCE NO. 419 - ADOPTING A REQUEST BY THE CITY OF COLLEGE PLACE TO EXPAND ITS URBAN GROWTH AREA BY 8.81 ACRES AND REDUCE THE CITY OF WALLA WALLA'S URBAN GROWTH AREA BY AMENDING COMPREHENSIVE PLAN MAP LU-1 AND MAP LU-3

Auditor File Number(s) of document being assigned or released:

Grantor

1. **Walla Walla County Commissioners**
- 2.
- 3.

Additional names on page ____ of document.

Grantee

1. **The Public**
- 2.
- 3.

Additional names on page ____ of document.

Legal description (i.e.: lot and block or section township and range)

Additional legal is on page ____ of document.

Assessors Parcel Numbers

**350725240059 350725130026 350725130021 350725240071 350725240072
35072540073**

Additional parcel number is on page ____ of document.

The Auditor/Recorder will rely on the information provided on this form. The staff will not read the document to verify the accuracy or completeness of the indexing information provided herein. Please type or print the information. This page becomes part of document.



**BOARD OF COUNTY COMMISSIONERS
WALLA WALLA COUNTY, WASHINGTON**

ORDINANCE NO. 419

ADOPTING A REQUEST BY THE CITY OF COLLEGE PLACE TO EXPAND ITS URBAN GROWTH AREA BY 8.81 ACRES AND REDUCE THE CITY OF WALLA WALLA'S URBAN GROWTH AREA BY AMENDING COMPREHENSIVE PLAN MAP LU-1 AND MAP LU-3.

WHEREAS, the Growth Management Act requires that the County take legislative action to review and revise, if necessary, its comprehensive land use plan to ensure that it complies with the requirements of the Growth Management Act, as described in RCW 36.70A.130; and

WHEREAS, the Growth Management Act requires that updates, amendments, or revisions to the Comprehensive Plan may not be considered more frequently than once a year except for certain limited circumstances; and

WHEREAS, RCW 36.70A.470 requires that the County include a procedure for any interested person to suggest amendments to the Comprehensive Plan or development regulations, and that the amendments must be docketed and considered on at least an annual basis.

NOW THEREFORE,

BE IT ORDAINED, by the Walla Walla County Board of County Commissioners that:

Section I. The Board of County Commissioners Makes the Following Findings of Fact:

1. The City of College Place requested the proposed amendment on March 30, 2012.
2. The amendment expands the College Place Urban Growth Area (UGA) and reduces the City of Walla Walla's UGA by 8.81 acres. The property in question is currently in the City of Walla Walla's UGA, but in the City of College Place's Water Service Area. A specific land use designation and rezone of the property has not been requested by the applicant.
3. On May 2, 2012 the Planning Commission held a public workshop.
4. On May 22, 2012 the Board of County Commissioners held a public workshop.
5. On May 24, 2012 a Notice of Public Hearing was published in the Waitsburg Times, Walla Walla Union-Bulletin, and Tri-City Herald.
6. On June 6, 2012 the Planning Commission held a public hearing and recommended the proposed amendment be carried over and considered on the County's 2013 preliminary docket.
7. On June 11, 2012 the Board of County Commissioners concurred in the recommendation of the Planning Commission.

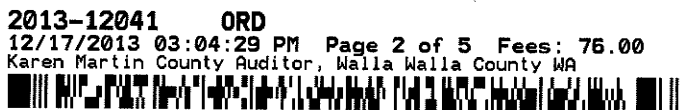

8. The Planning Commission held a public workshop on May 1, 2013.
9. The Board of County Commissioners held a public workshop on June 4, 2013.
10. On June 5, 2013 the Planning Commission held a public hearing and recommended the proposed amendments be included on the County's 2013 final docket.
11. On June 10, 2013 the Board of County Commissioners concurred in the recommendation of the Planning Commission.
12. On June 11, 2013 the Department of Commerce acknowledged receiving the proposed amendment.
13. No comments were received from the Department of Commerce or any other public entity during the 60 day comment period.
14. On August 13, 2013, the Walla Walla Joint Community Development Agency issued a SEPA determination of non-significance. No appeal was filed.
15. On August 22, 2013 a Notice of Informational Public Meeting and Public Hearing was published in the Waitsburg Times, Walla Walla Union Bulletin, and Tri-City Herald.
16. On September 4, 2013 an Informational Public Meeting and Planning Commission Public Workshop were held.
17. On September 19, 2013 a Notice of Public Hearing was published in the Waitsburg Times, Walla Walla Union Bulletin and Tri-City Herald.
18. On October 2, 2013 the Planning Commission held the 2013 Comprehensive Plan and Development Regulations Amendment Final Docket hearing.
19. On October 7, 2013, the Planning Commission issued Resolution 13-03, recommending approval of the proposed amendment.
20. On November 7, 2013 the Notice of Public Hearing was published in the Waitsburg Times, Walla Walla Union-Bulletin and Tri-City Herald.
21. The Board of County Commissioners held the 2013 Comprehensive Plan and Development Regulations Amendment Final Docket Hearing on November 25, 2013.

Section II. The Board of County Commissioners Makes the Following Conclusions of Law:

1. The proposed amendment is in compliance with Walla Walla County Code Sections 14.10.070(B)(3).
2. The proposed amendment is consistent with the Walla Walla County Comprehensive Plan.
3. As proposed, the amendment will not have a significant adverse impact on public welfare and safety.
4. The proposed amendments are in compliance with RCW 36.70A, RCW 36.70B and the Washington Administrative Code.



Section III. Adoption of the Proposed City of College Place Urban Growth Area Expansion and Amended Land Use Maps:

Based on its review of the requirements of RCW 36.70A and the Washington Administrative Code, the proposed amendment prepared by the applicant, staff analysis and the recommendation proposed by the Planning Commission, the Board of County Commissioners hereby adopts the following proposed Comprehensive Plan amendment:

The adjustment of the Urban Growth Area and amendment to Walla Walla County Comprehensive Land Use Map LU-1 and LU-3 as presented to the Board of County Commissioners on this date is adopted as shown in Exhibit A. The Director of the Walla Walla Joint Community Development Agency is directed to replace the existing maps with the amended maps.

Section IV. Effective Date and Savings.

This Ordinance is effective upon signing.

Section V. Severability.

If any section, subsection, paragraph, sentence, clause or phrase of this Ordinance is declared unconstitutional or invalid for any reason, such decision shall not affect the validity of the remaining parts of this ordinance.

Section VI. Publication.

This Ordinance will be published by an approved summary consisting of the title.

PASSED by the Walla Walla County Board of County Commissioners in regular session at Walla Walla, Washington, then signed by its membership and attested by its Clerk in authorization of such passage this 16th day of December, 2013.

Attest:

Connie R Vinti
Connie R. Vinti, Clerk of the Board

Perry L. Dozier
Perry L. Dozier, Chairman, District 2

absent
James K. Johnson, Commissioner, District 1

Gregory A. Tompkins
Gregory A. Tompkins, Commissioner, District 3

*Constituting the Board of County Commissioners
of Walla Walla County, Washington*

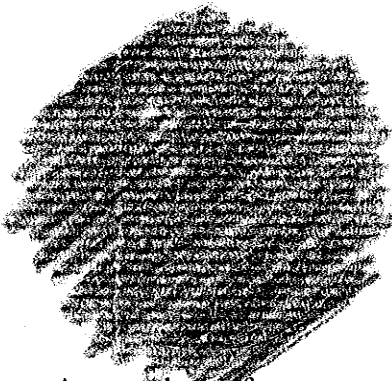

Approved as to form

Jesse D. Nolte
Jesse D. Nolte, Deputy Prosecuting Attorney



Exhibit A

College Place Land Use Map Amendment (CPA2012-006)

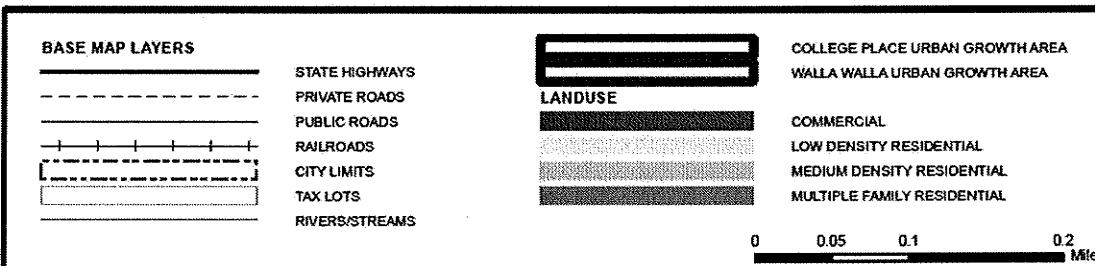
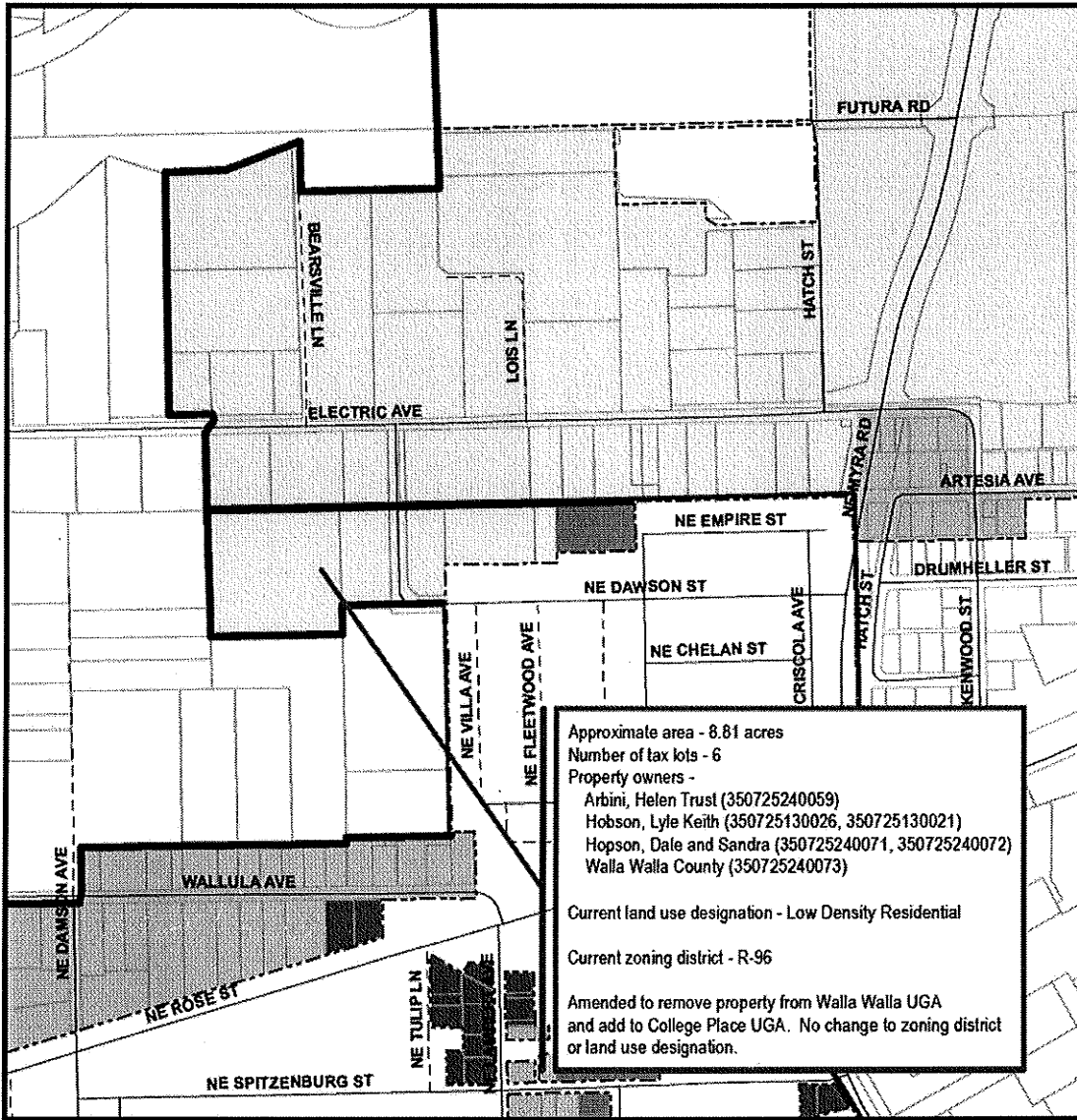

Print Date: 12/10/2013

Walla Walla Joint Community Development Agency (WWJCDA) - 55 E. Moore Street, Walla Walla WA 99362 - (509) 524-4710

